

## FEATURES

- Rotates a mounted screen from landscape to portrait orientation
- Recommended for screens between 37" - 65"
- Max load: 70kg (154lbs)
- Fits screens with VESA® patterns: 200 x 200mm, 300 x 300mm and 400 x 400mm
- 90° toolless rotation
- Can be locked at any angle
- Suitable for interactive touchscreens
- Adjustable tilt up to -4.5°, ideal for Samsung Flip®
- Depth from wall: 75mm (at 0° tilt)
- Can be used as a standalone wall mount or attached to a suitable screen mount
- Compatible with B-Tech's System X range and B-Tech collars for pole mounted installations
- Integrated cable management
- Keyhole mounting for a quick and easy installation

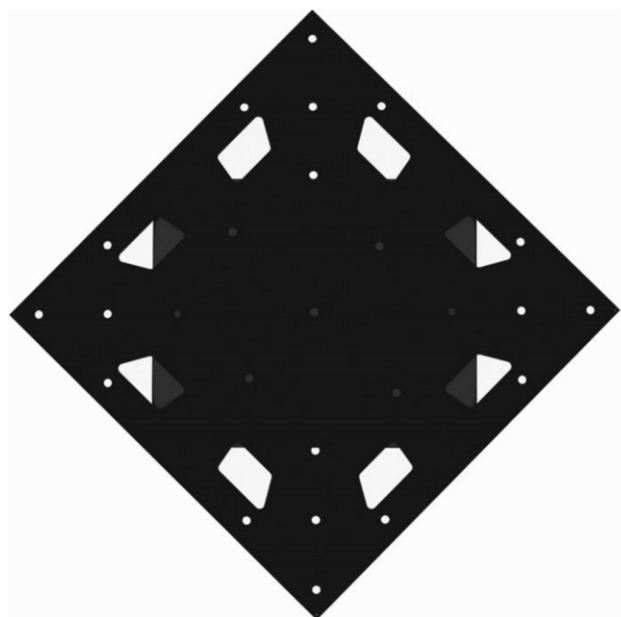

## CONTENTS

|                                |    |
|--------------------------------|----|
| Installation Safety Notes..... | 2  |
| Parts List.....                | 4  |
| Installation Instructions..... | 5  |
| Installation Example.....      | 10 |
| Product Dimensions.....        | 11 |
| B-Tech Contact Details.....    | 12 |

## INSTALLATION TOOLS REQUIRED

13mm (1/2") Spanner



Crosshead screwdriver



Drill



10mm (7/16") Masonry  
or 6mm (1/4") Wood  
Drill Bit



Pencil



Stud finder  
(optional)



**MM-BT7550**  
**PARTS LIST**

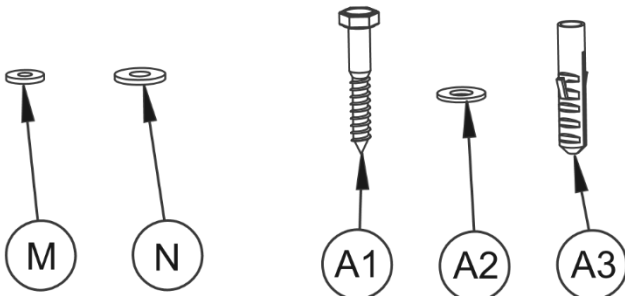
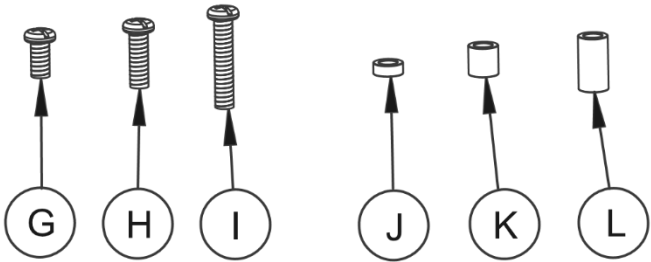
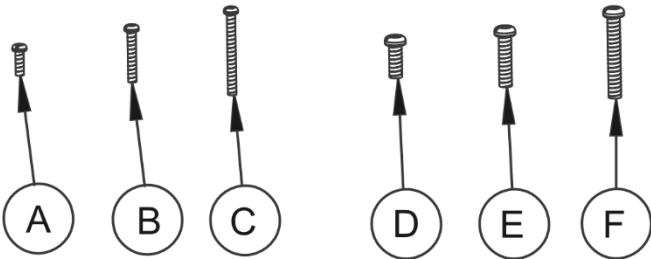
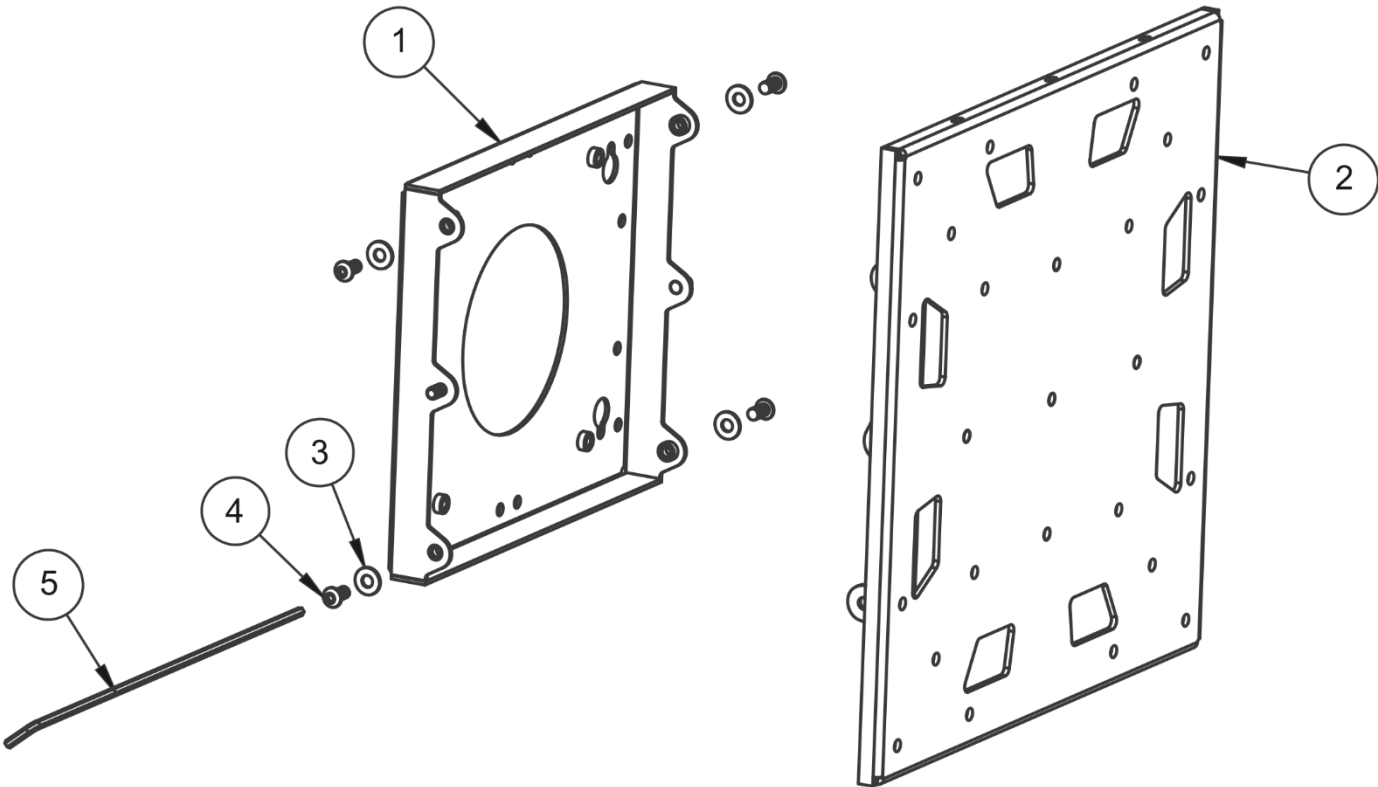

| Item          | Part Name             | Qty |
|---------------|-----------------------|-----|
| 1             | MOUNTING PLATE        | 1   |
| 2             | INTERFACE PLATE       | 1   |
| 3             | M8 PLASTIC WASHER     | 4   |
| 4             | M8 x 16mm SCREW       | 4   |
| 5             | 5mm HEX KEY           | 1   |
| Interface Kit |                       |     |
| A             | M4 x 16mm SCREW       | 4   |
| B             | M4 x 25mm SCREW       | 4   |
| C             | M4 x 40mm SCREW       | 4   |
| D             | M6 x 16mm SCREW       | 4   |
| E             | M6 x 25mm SCREW       | 4   |
| F             | M6 x 40mm SCREW       | 4   |
| G             | M8 x 16mm SCREW       | 4   |
| H             | M8 x 25mm SCREW       | 4   |
| I             | M8 x 40mm SCREW       | 4   |
| J             | M8 x 5mm SPACER       | 4   |
| K             | M8 x 13mm SPACER      | 4   |
| L             | M8 x 24mm SPACER      | 4   |
| M             | M4 METAL WASHER       | 4   |
| N             | M6 METAL WASHER       | 4   |
| Fixing Kit    |                       |     |
| A1            | M8 x 50mm COACH SCREW | 4   |
| A2            | M8 METAL WASHER       | 4   |
| A3            | N° 10 WALL PLUG       | 4   |

PLEASE KEEP THIS FOR FUTURE REFERENCE

# INSTALLATION INSTRUCTIONS

1

## Fix Mounting Plate

- i. Mark and drill four fixing holes and insert item A3 into the holes. Screw two of item A1 into the top holes, do not fully tighten. Allow a gap (approx 10mm) to hook on item 1.

### A. WALL MOUNTING

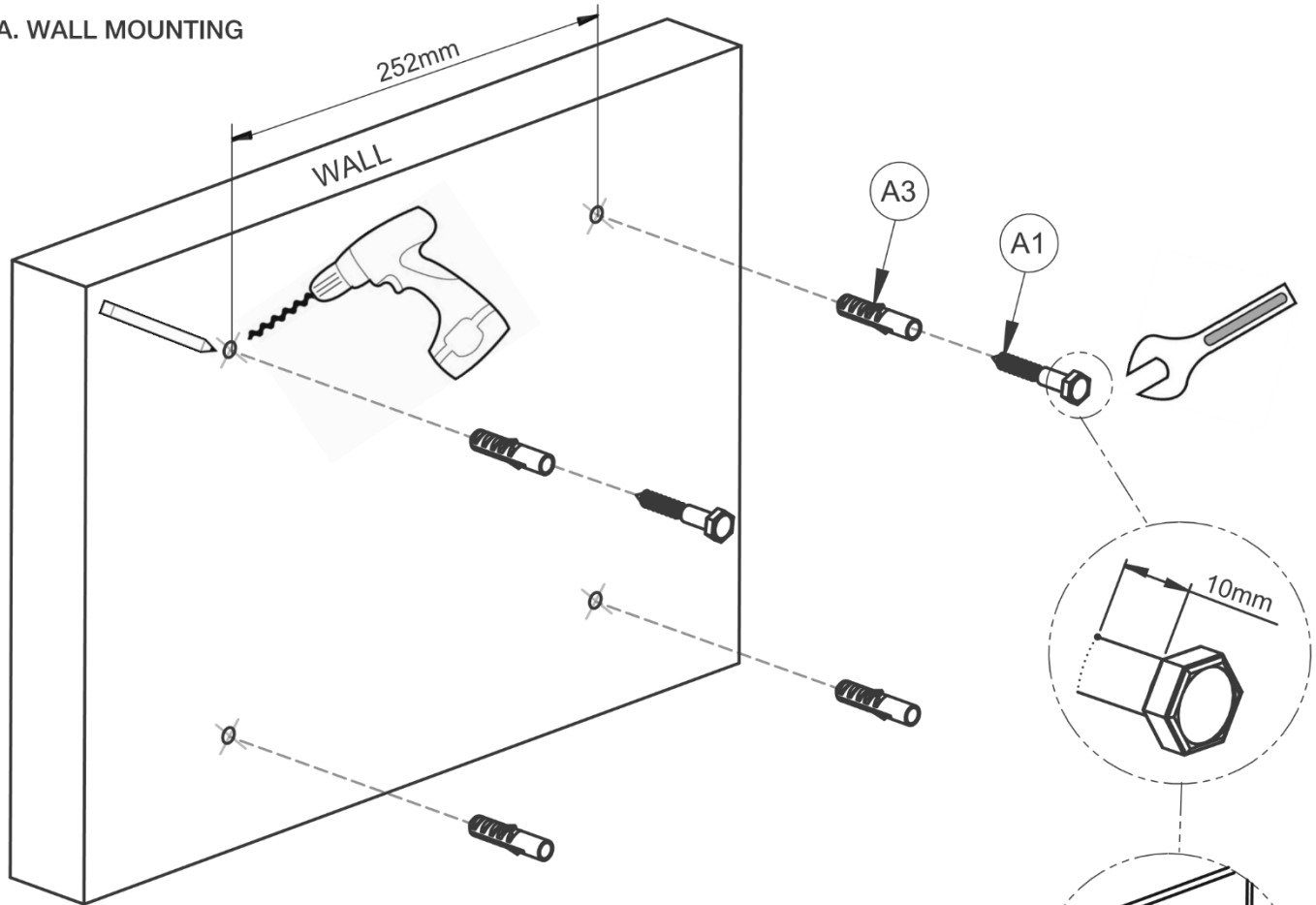

- ii. Hook on item 1 using keyholes. Screw items A1 into the remaining holes and tighten all fixings.

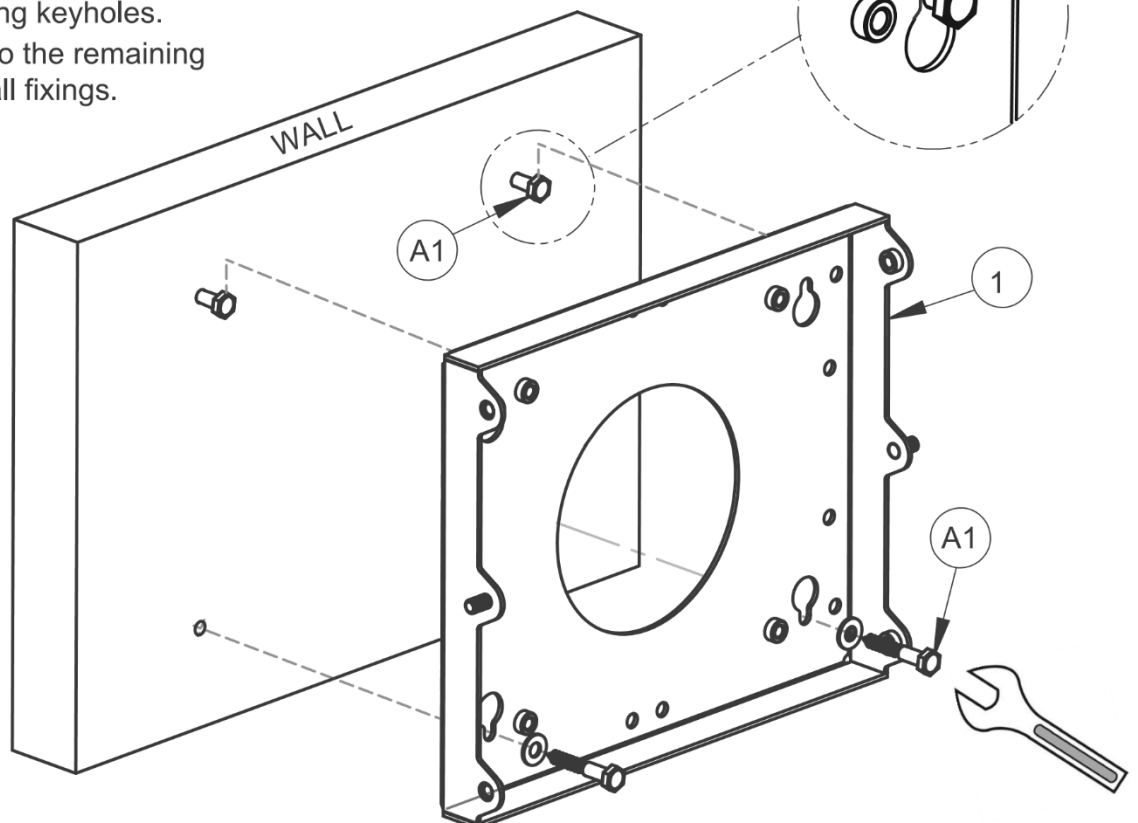

## B. SINGLE POLE MOUNTING

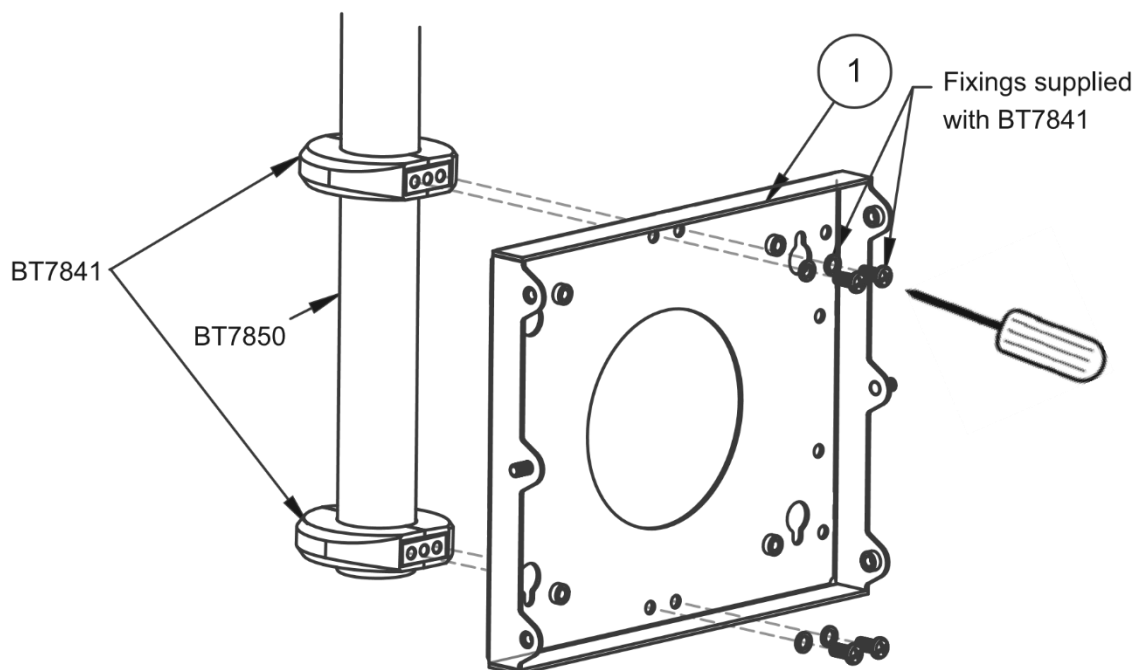

## C. DOUBLE POLE MOUNTING

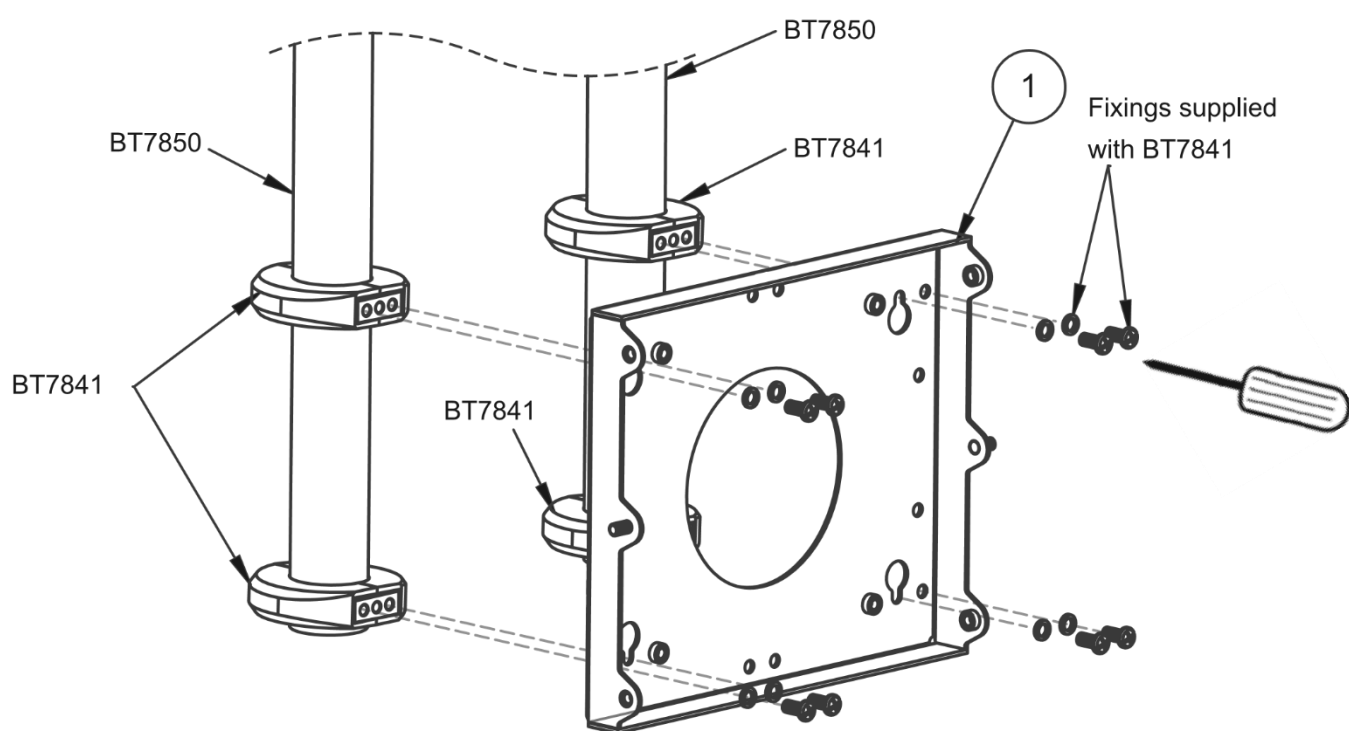

## 2

### Attach Interface Plate to Screen

Attach item 2 to the rear of the screen using the interface kit provided.

**Note:** If the screen needs to rotate in an anti-clockwise direction.

Set the angle to 90° on item 2 before attaching the plate to the screen.

See below if the installation requires the screen to be locked at an angle.

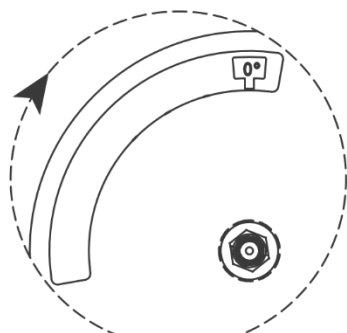

Preset at 0° for a clockwise screen rotation

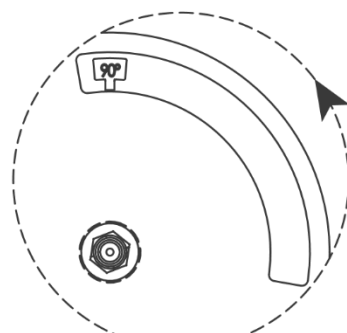

Reset to 90° for an anti-clockwise screen rotation

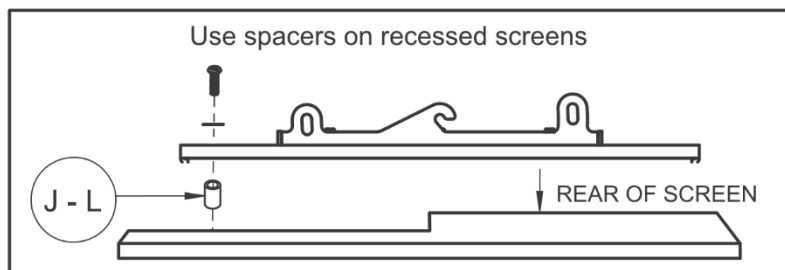
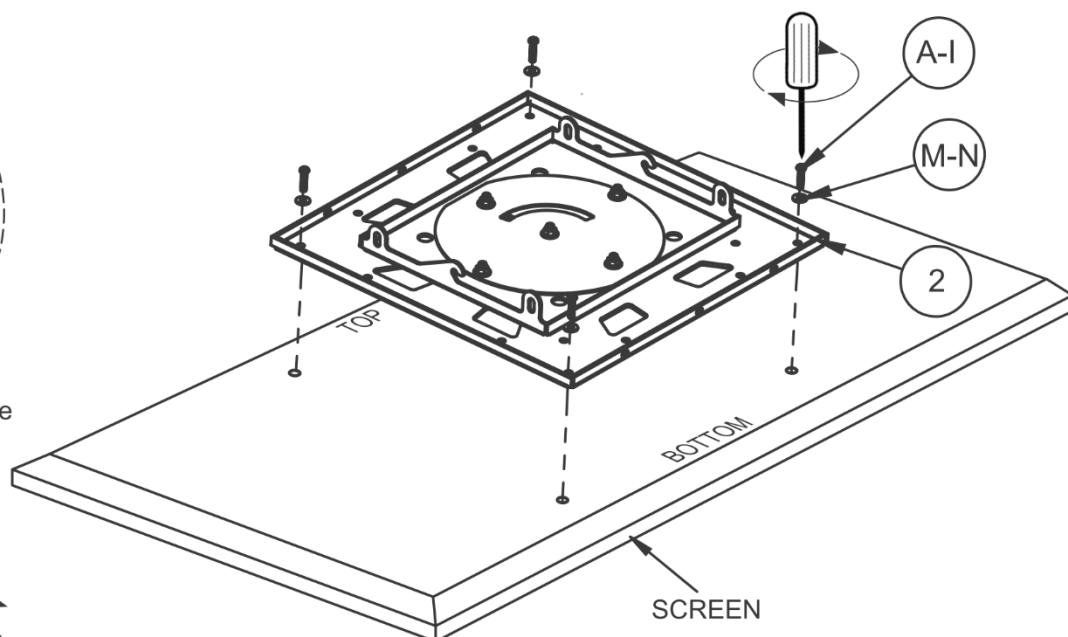

### Lock Angle (Optional)

If the installation requires the screen to be locked in position, set the angle on the rotation plate before attaching item 2 to the screen. Use a 13mm spanner to fully tighten all the M8 Nuts on item 2, preventing any further rotation.

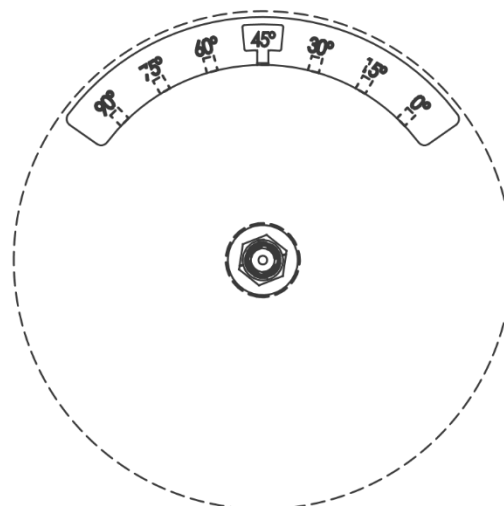
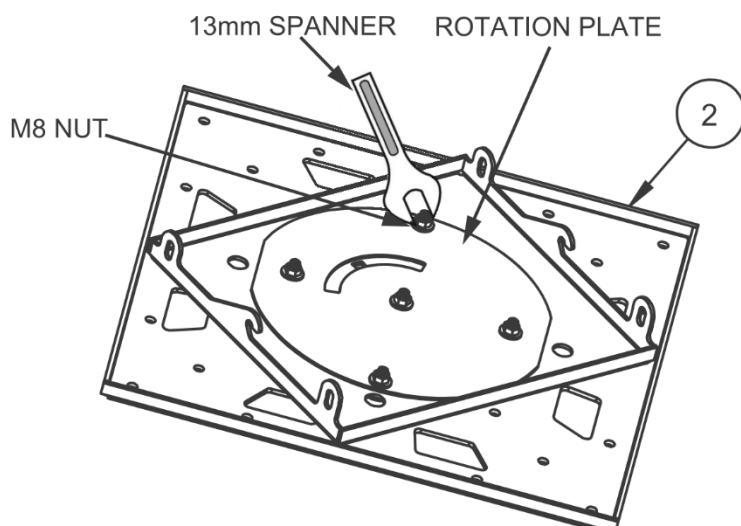

Angle guide shows:  
0°, 15°, 30°, 45°, 60°, 75° and 90°

3

### Hook Screen onto the Mounting Plate

Hook screen onto item 1.

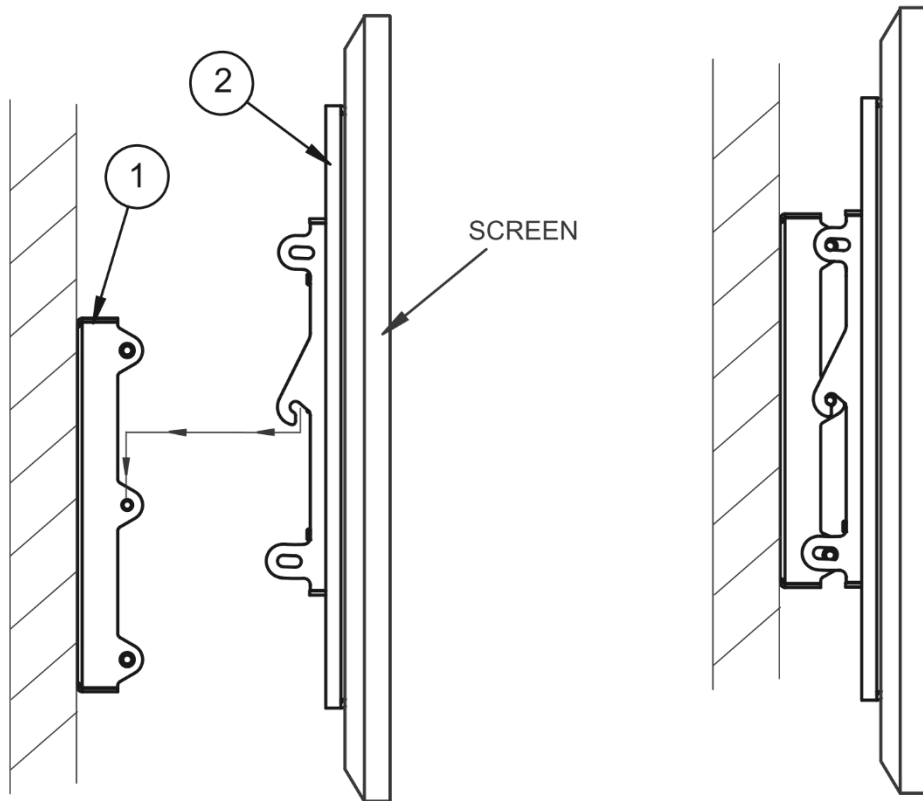

4

### Secure Interface Plate on Mounting Plate and Set Tilt (if required)

Insert items 3 & 4 into items 1 & 2. Do not fully tighten until the tilt has been set.

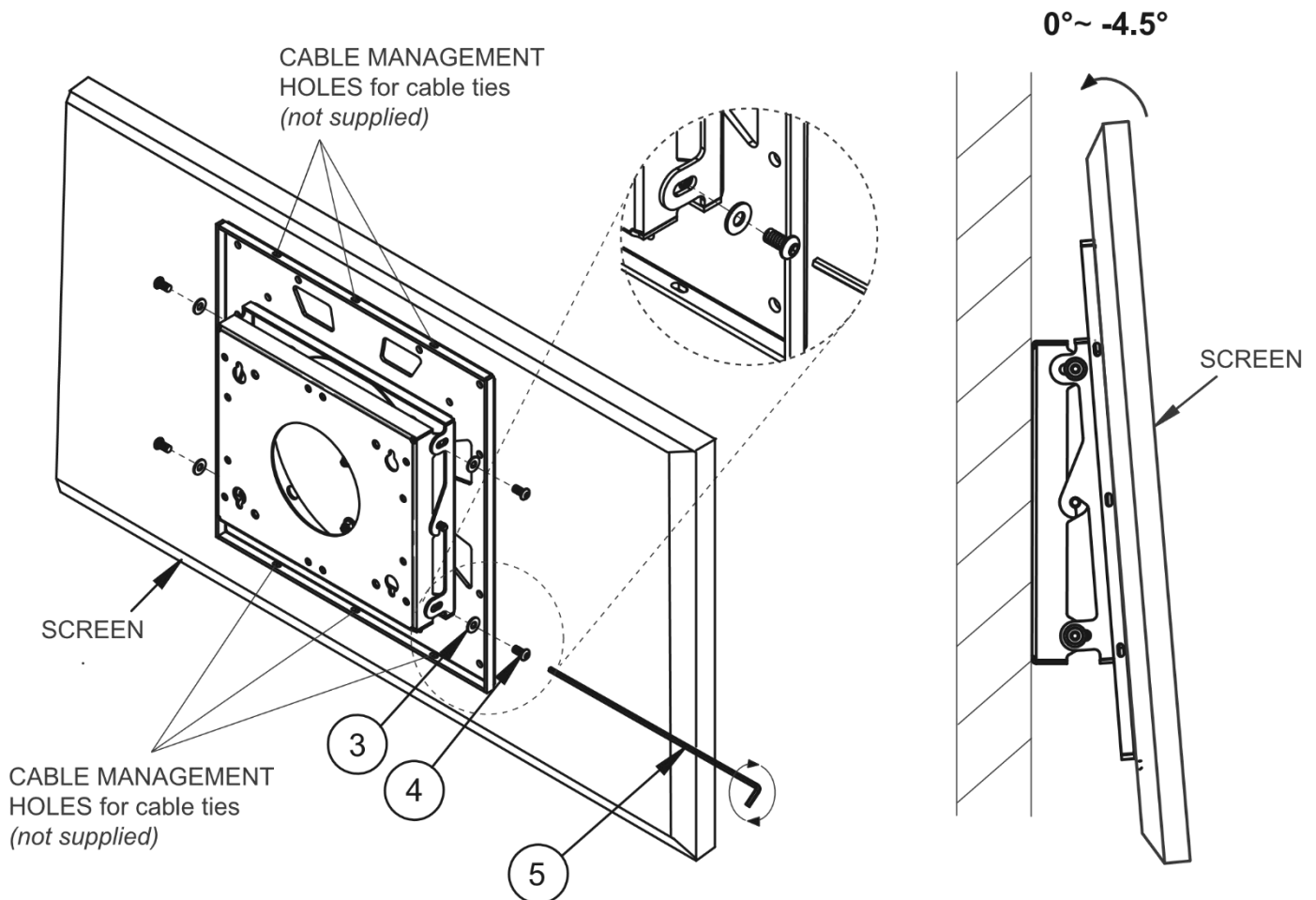

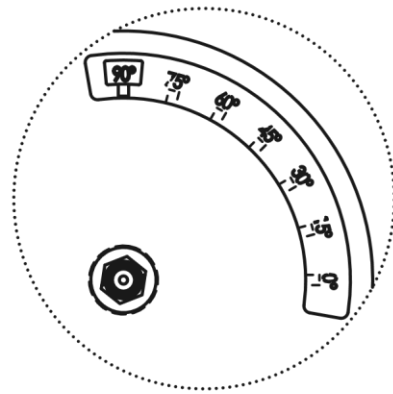
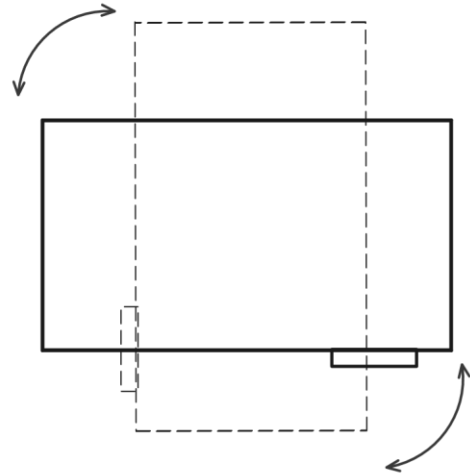
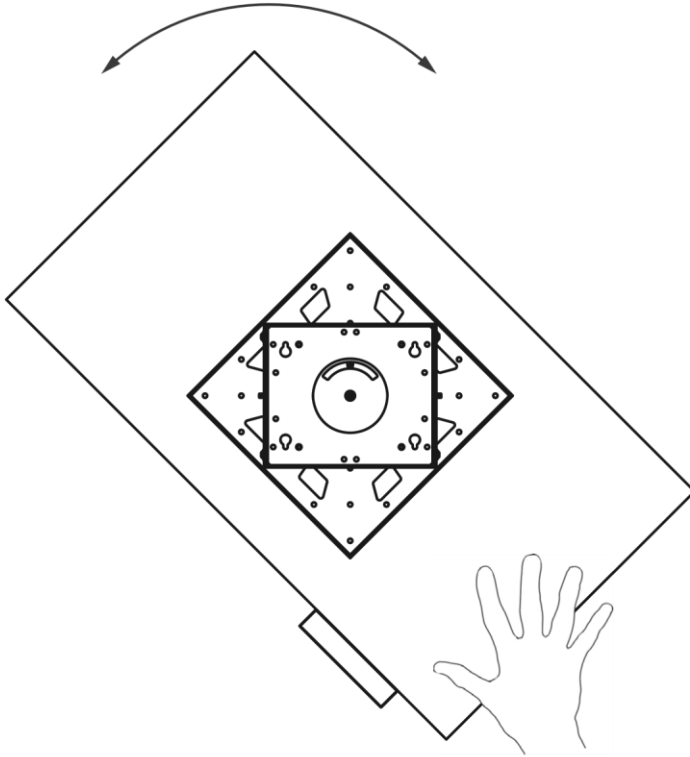
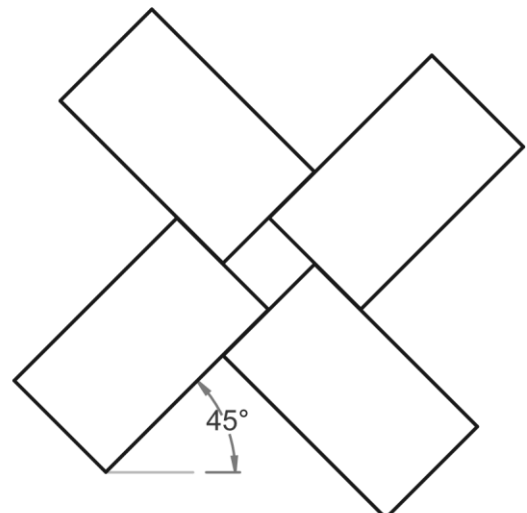
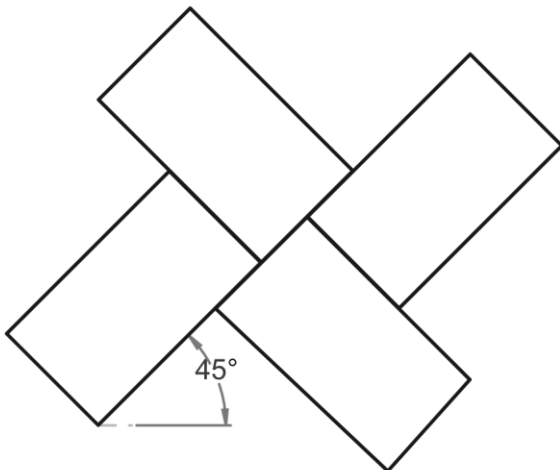
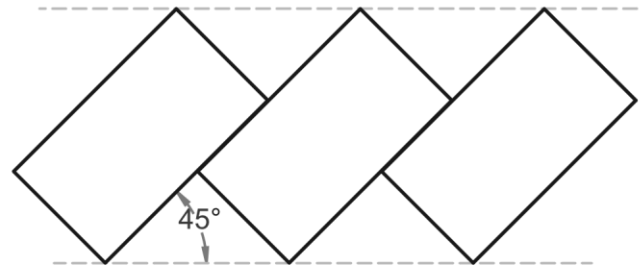
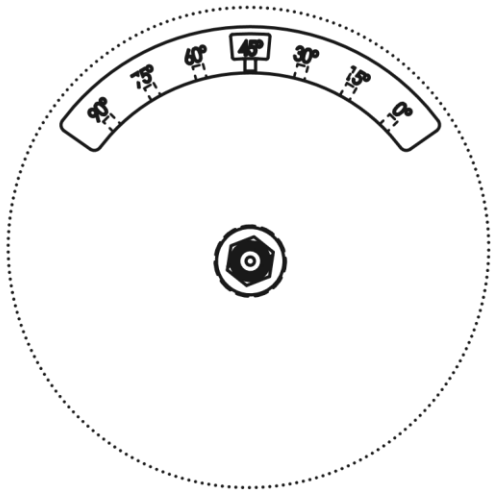
**Free Rotation** $0^{\circ}\sim 90^{\circ}$ **EXAMPLES OF 45° MULTI-SCREEN INSTALLATIONS**

# MM-BT7550

## PRODUCT DIMENSIONS

FRONT  
VIEW

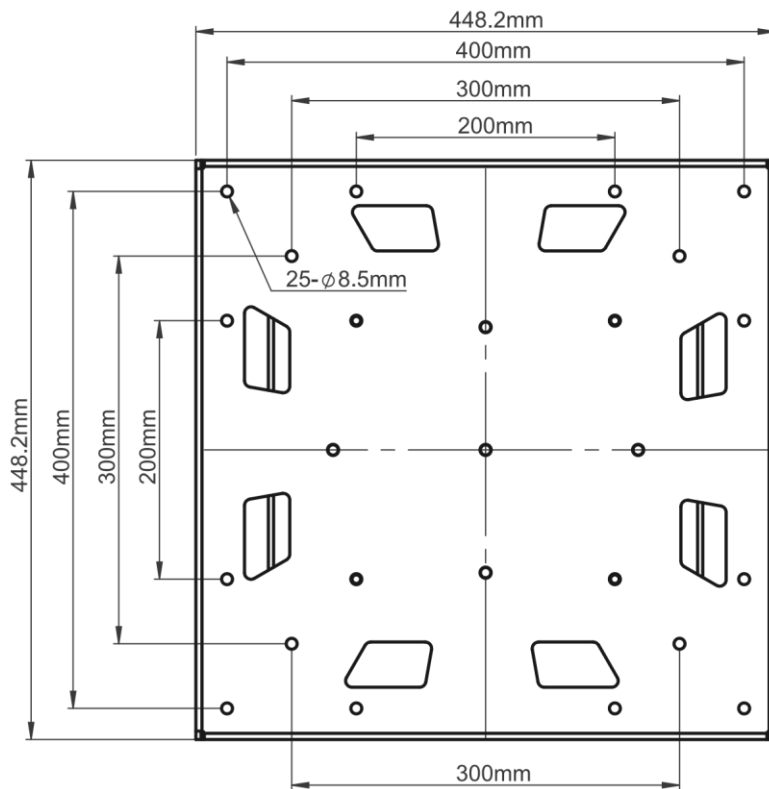

SIDE  
VIEW  
0° TILT

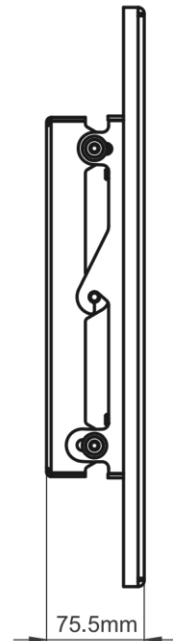

BACK  
VIEW

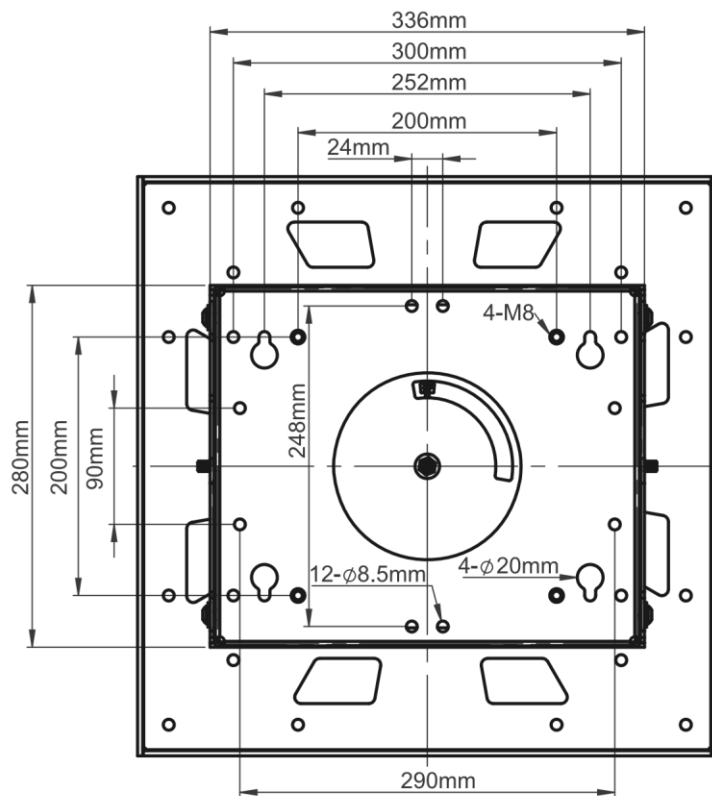

SIDE  
VIEW  
-4.5° TILT

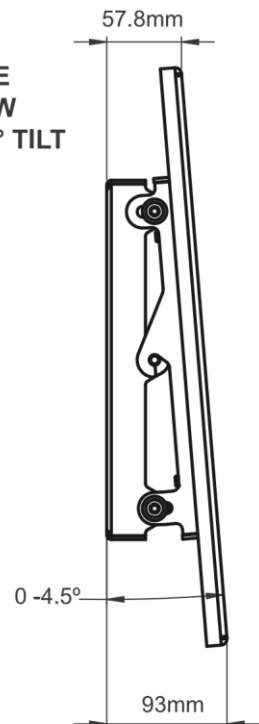

TOP  
VIEW

