

RF&POWER

Function	Frequency	Maximum Output Power (EIRP)
WiFi	2412-2472 MHz	19.60 dBm
	5180-5240 MHz	22.75 dBm
	5260-5320 MHz	22.76 dBm
	5500-5700 MHz	22.88 dBm
	5745-5825MHz	13.67 dBm
5955-6415MHz	21.78 dBm	
Bluetooth	2402-2480 MHz	13.39 dBm
BLE	2402-2480 MHz	8.97 dBm

Here, Shenzhen Decenta Technology Co., Ltd. declares that the OPS PC Module complies with Directive 2014/53/EU Radio Equipment Directive, 2011/65/EU RoHS Directive, Radio Equipment Regulation 2017 and The Restriction of the Use of Certain Hazardous Substances in Electrical and Electronic Equipment Regulations 2012.

The full text of the EU and UK declaration of the conformity is available at the following internet address: <https://iiyama.com>

Please refer to <https://iiyama.com> to download the User manual and driver.

SAFETY WARNING

- Before using and operating this device, please read thoroughly and comply with the following precautions in order to prevent accidents or mal-operations.
- Do not charge or use the device in dusty or wet conditions, to prevent internal circuit failure.
- Keep the device away from heat sources such as an electric heater.
- This device and its parts may contain some small components, so keep the product out of reach of children to prevent accidents.
- This device is not water-resistant, please keep it dry.
- The normal working temperature for the product is 0°C~40°C, and the normal working humidity is 10%~95%.
- Please contact professional service personnel for maintenance services.
- Do not insert any sharp or pointed object into the device.
- Prevent the device from falls and collisions with other objects, which may cause damages.
- There are heating hole on back cover, do not spray water to it or use damp cloth for cleaning;
- Please call professional personnel for maintenance service.

STATEMENT

The image shown in this manual is indicative only. If there is inconsistency between the image and the actual product, the actual product shall govern.

iiyama

User Manual

**OPS PC Module
ADLPOPS13
(OPC51201xx series)**



We recommend recycling of used product. Please contact your dealer or iiyama service center. Recycle information is obtained via the Internet, using the address: <https://iiyama.com> You can access the Web page of different countries from there.

xx: RAM and SSD size control code

CHECKING THE CONTENTS OF THE PACKAGE

- OPS PC Module x 1
- Installation manual x 1 (this document)



INSTALLATION PROCEDURE

- NOTE**
- Before mounting and using the Monitor, please follow the steps below to install the OPS PC Module. The installation should be performed by at least two adult persons to avoid danger and injuries.
 - Please make sure the power cable of the Monitor is disconnected before installation.
 - Do not plug or unplug the OPS PC Module while the monitor is powered on. OPC PC module may be broken.
 - When using for the first time, if the screen is blurred, flickering, no signal, etc. after booting, OPS PC Module may not be installed correctly; please check the installation status or reinstall it.

1. Remove OPS PC Module backplane

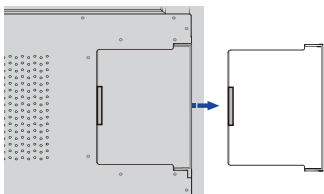

2. Insert OPS PC Module into the panel slot

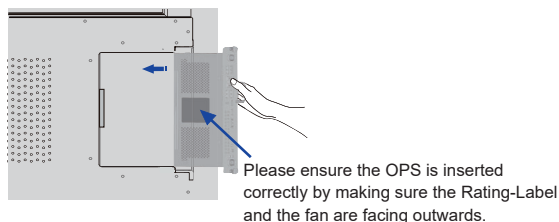

3. Fix the screws or mounting ears and tighten it

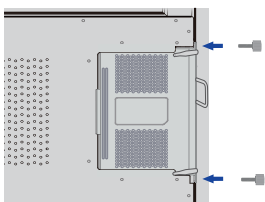

4. Press the power button to turn it on and operate like a regular computer

OPS PC MODULE SPECIFICATION

Product Specification	
Type	OPS PC Module
CPU	Gen12 i5-1240P
RAM	DDR4 3200MHz 16GB, Max. 32GB
SSD	PCIe 256GB, Max. 1T
Graphics	Integrated Intel® Iris® Xe Graphics eligible 80EU
Sound Card	Integrated High Definition Audio
Ethernet Card	Integrated 10M/100M/1000M Adaption Intel I219-LM (vPro ethernet card)
Wi-Fi	Intel AX210/AX211 + BT5.3 Support 802.11a/b/g/n/ac/ax (Wifi 6E) Speed: 2.4Gbps
Bluetooth	5.3
Operating system	Windows 11 IoT Enterprise (SAC) 64Bit
Security Device Support	TPM2.0
I/O Port	
Antenna	2
USB2.0 (DC5V, 500mA)	2
USB3.0 (DC5V, 900mA)	2
Thunderbolt 4 (DC5V, 3A) (Support DP ALT mode)	2
HDMI OUT (Max resolution 3840 x 2160 60Hz)	1
Audio IN and OUT combo	1
RJ45	1
HDD LED (Running : red LED blinking)	1

I/O Port	
POWER LED (Power on : green LED)	1
80 PIN	Support
Kensington Lock	1
Power Button	1
Power	
Power Requirements	12-19Vdc, 60W
Max Power	95W
Standby Power	0.5W
Physical Specification	
Dimension	180.0 x 119.0 x 30.0 mm (L x W x H)
Dimension(package)	267.0 x 215.0 x 65.0 mm (L x W x H)
Net Weight	0.75kg
Gross Weight	0.95kg
Environmental Condition	
Operation Temperature	0°C to 40°C
Operation Humidity	10% to 95% RH (non condensing)
Storage Temperature	-10°C to 50°C
Storage Humidity	10% to 95% RH (non condensing)